

# Continuous flow dryers GM, GL, GXL

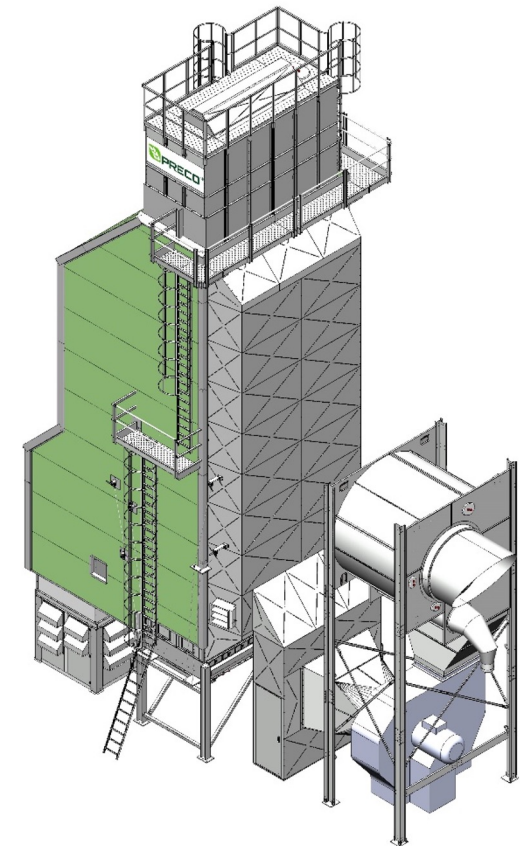

Dryer is intended for drying bulk materials as wheat, rape, corn, sunflower seeds etc. Dryer is designed in industrial performance. Dryers are made of **galvanized sheet metal**, ZN 275 g/m<sup>2</sup>. **Environment working temperature** is from 0 ° C to + 45 ° C.

Warranty time: 24 months. Continuous flow dryers have models based on capacity and volume.



Dryer's sections						
Type	Inside dimensions			Max.nb.of sections	Section's volume	Grain volume in section
	Width (W)	Length (L)	Height (H)			
	mm					
<b>GM</b>	2150	1920	1150	10	4.75	3.75
<b>GL</b>	3010	1920	1150	12	6.65	5.25
<b>GXL</b>	4300	1920	1150	18	9.49	7.49

# Continuous flow dryers GM, GL, GXL



## STANDARD EQUIPMENT

- Roof, equipped with access ladders and safety rails
- Buffer section with level sensors
- Drying column with triangular hot and cold air channels
- Cooling sections, adjustable by valves
- Burner chamber equipped with air intake pockets, dust sie and access door
- Hot air mixing duct
- Hot air distribution chamber in the drying zone
- Modulating gas or diesel burner
- Exhaust air chamber
- Exhaust fans (radial) with adjustable air flow
- Discharge section with electric drive
- Platforms, hatches and ladders for easy access to service areas.

